

CATALOG NUMBER	"A" INTERFACE
A008-L33-05	FULL DETENT
A008-L34-05	LIMITED DETENT
A008-L35-05	SMOOTH BORE

MATERIAL AND FINISH

HOUSING AND CENTER CONTACT: BeCu; GOLD PLATE 75 MICROINCHES TYPICAL  
OVER NICKEL PLATE 100 MICROINCHES TYPICAL

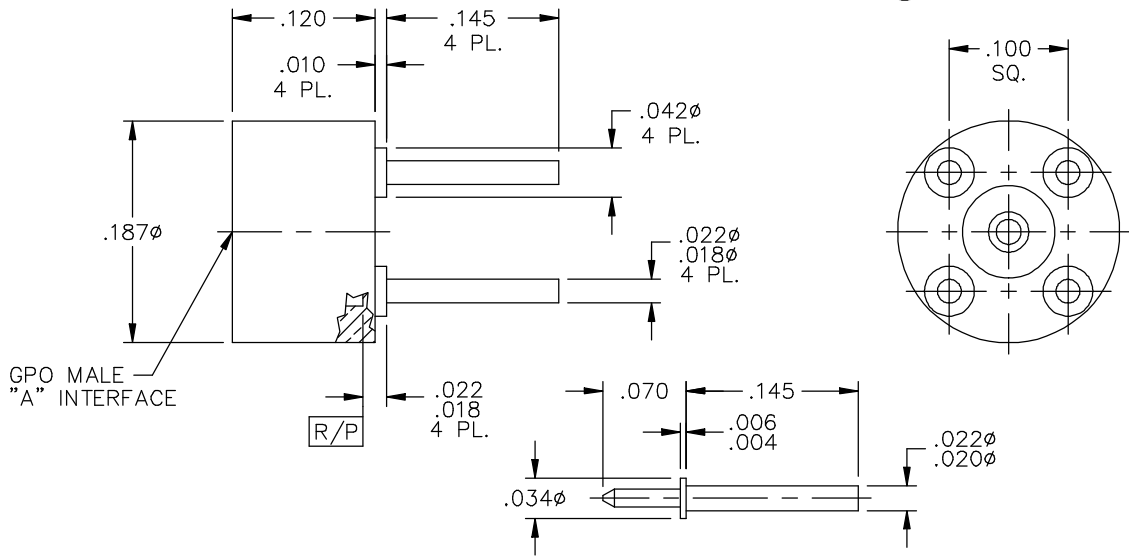
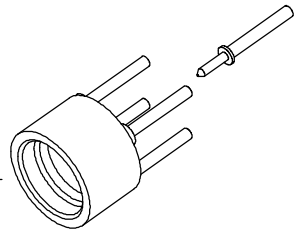

RECOMMENDED MOUNTING HOLES

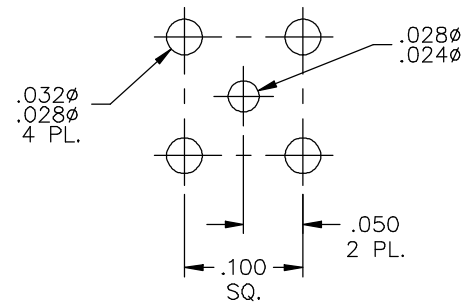

This drawing and any data contained herein is the property of Corning Gilbert Inc., and constitutes and contains proprietary and confidential information. Neither receipt nor possession of this drawing confers or transfers any right to duplicate, use or disclose any information contained herein except as expressly authorized by Corning Gilbert Inc.

GPO MALE STRAIGHT TO PCB WITH SEPARATE PIN (TAB DETENT)	IDENT CODE: 82316	<b>Corning Gilbert Inc.</b>
	REVISION: B	
SOURCE FILE: MECR# 1583	DWG. NO.: OL-A008-L3X-05	ASSY. PROC.: -